

## L10 WINDOWS/ ROOFLIGHTS/ SCREENS/ LOUVRES

- 210 WOOD WINDOWS
- 250 WOOD WINDOWS
- 260 WOOD WINDOWS

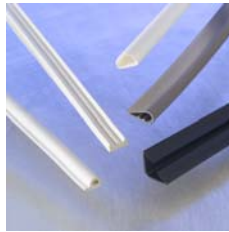

Lorient's Integrity™ Architectural Seals range includes a selection of elastomeric seals, which are suitable for use on windows as well as doors. Refer to the 1000 series in our Integrity™ ring binder for full details.

## U90 GENERAL VENTILATION – DOMESTIC

### 360 AIR TRANSFER GRILLES: . . . . .

All of Lorient's range of Fire & Smoke Resisting Damper/Air Transfer Grilles are listed in this section. These include:

**LVN20 / LVN25** – non-vision style air transfer grilles, with angled slats to ensure complete visual privacy. These grilles can provide up to 60 minutes fire protection in doors.

**LVV40 / LVC40** – a vision-style range, with excellent airflow characteristics, providing up to 60 minutes fire protection in doors, walls and ducts. Can be used with a choice of cover grilles for additional privacy.

**LVH44 / LVHC44** – a high performance range of heavy duty grilles, suitable for use in a variety of applications, including aggressive industrial environments, floors and ceilings.

**“Talkback” smoke control system.** Intumescent air transfer grilles are extremely effective at resisting the movement of hot gases and fire, but will still allow the passage of smoke at room temperatures. With this problem in mind, the Lorient design team produced a range of automatic damper/shutter assemblies for use with the intumescent air transfer grilles. A fail-safe motorised actuator, linked to a smoke control system, will close the shutter plates as soon as smoke is detected. Once the spread of fire has reached the air transfer grille, the intumescent material will expand to protect from fire and hot gases. The Talkback system can control up to sixteen assemblies, and provides sophisticated remote monitoring, fail-safe, auto-testing and fully automatic reset.

To specify the Talkback smoke control system, select the **LVN20S, LVV40S, LVH20S** or **LVH44S** options.

Our air transfer grilles are also referred to in the L20 and P21 section clauses.

Refer to our Fire & Smoke Resisting Damper/Air Transfer Grilles brochure for full details of products, applications and fire and smoke performance.



Lorient's LVN and LVV ranges.



Lorient's high performance LVH44 range.

Below: Lorient's "Talkback" smoke control shutter system, in open and closed positions.

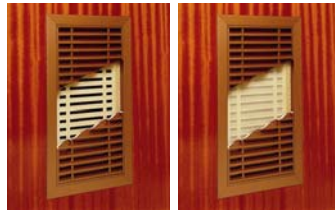

Lorient Polyproducts Ltd, Fairfax Road, Heathfield Industrial Estate, Newton Abbot, Devon TQ12 6UD  
Tel: +44 (0) 1626 834252 Fax: +44 (0) 1626 833166 e-mail: mktg@lorientuk.com  
[www.lorientgroup.com](http://www.lorientgroup.com)



Quality Assurance  
BS EN ISO 9001:2000  
Certificate No. Q6104



## Specifying Lorient with NBS Plus



Lorient is delighted to announce its inclusion in the NBS Plus specification system, as from the May 2005 circulation.

This leaflet gives details of the thirty-six NBS Plus clauses where you will find Lorient's fire, smoke and acoustic containment products listed – and some of the solutions we particularly recommend for those applications. Our wide product range is backed by test evidence and numerous third party approvals and accreditations, such as BBA and CERTIFIRE – so you can confidently specify Lorient products throughout your project.

Using the system couldn't be more straightforward – select the appropriate clause for your specification, click on the Lorient logo, scroll to the Lorient product of your choice, and "drag and drop" the red text into your specification.

We hope you will find this quick reference guide helpful, but to ensure you have all the relevant information to hand, please remember to also refer to our detailed product brochures as you use the NBS Plus system. And, if you have any questions at all, or would like a copy of the full specification text for all our products, please don't hesitate to call us - we will be more than happy to help.

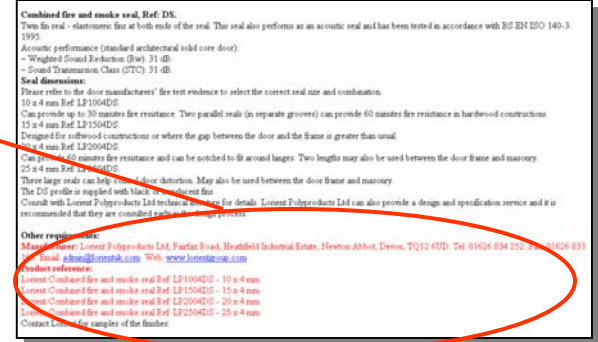

## L10 WINDOWS/ ROOFLIGHTS/ SCREENS/ LOUVRES

### 510 GLAZED WOOD SCREENS

This section includes Lorient's comprehensive range of glazing systems – **System-36**, **System-90 PLUS**, **System-630**, and **System-69**. All these products are suitable for use in glazed screens and partitions, and Lorient has test evidence for a variety of glass types, sizes and fire ratings – refer to our Fire Resistant Glazing Systems brochure for full details. All our fire resistant glazing systems carry CERTIFIRE approval.

Our glazing systems are also suitable for use in door applications – you will find them referred to in the L20 section clauses.

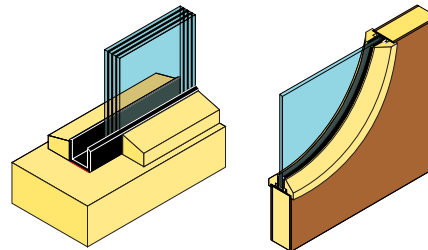

Left: Lorient System-36/15 in a screen, System-630 in a door.

Right: System-90 PLUS in a screen.



CF184/CF185  
CF201/CF202  
CF325/CF327



## L20 DOORS/ SHUTTERS/ HATCHES

- 230 WOOD FLUSH DOORS: . . . . .
- 250 WOOD PANNELLED DOORS: . . . . .
- 270 WOOD DOORS: . . . . .
- 280 DOORS: . . . . .
- 310 WOOD DOOR FRAMES: . . . . .
- 330 WOOD DOOR FRAMES: . . . . .
- 370 DOOR FRAMES: . . . . .
- 410 WOOD DOORSETS: . . . . .
- 420 WOOD DOORSETS: . . . . .
- 430 WOOD DOORSETS: . . . . .



The Lorient DS range.



The Finesse.

Throughout these sections, you'll find Lorient's complete range of fire and smoke seals for door assemblies – including our latest innovation, the **DS combined fire, smoke and acoustic seal**. The ingenious design of the DS means that one of its dual fins can be trimmed around ironmongery, leaving one continuous seal intact for optimum smoke and acoustic protection. Developed to meet the requirements of Approved Documents B, E and M, the DS is available in a range of standard sizes for use on both 30 and 60 minute doors throughout any project.

For your prestige projects, the **Finesse** provides the ultimate solution for performance and aesthetics. With clear fins as standard, and woodgrain finishes available, the Finesse is styled to blend discreetly into its surroundings. For 15 x 4mm and 20 x 4mm seals, change the DS text to Finesse in your specification.

Both the DS and Finesse seals carry BBA and CERTIFIRE certification (CF330).

Lorient's Integrity™ Architectural Seals range also features throughout these sections – and there are plenty of choices! The products pictured here are some we would particularly recommend. The **IS8010 si** automatic threshold seal can be used on fire rated or non-fire rated doors, and is an excellent complement to the DS or Finesse for acoustic solutions. It also carries CERTIFIRE certification (CF136).



IS7061, IS7025, IS8010 si, IS4120 and IS1010 Batwing®.

The **IS7061** brings all the smoke and acoustic benefits of our popular Batwing® seal, to the meeting stiles of double doors.

Lorient's fire resistant glazing systems, door furniture and air transfer grilles also feature throughout these sections.

### 460 FRAMELESS GLASS DOORS: . . . . .

Select the **IS7140** for 12mm glass doors, and the **IS7150** for 15mm doors.

### 480 DOORSETS: . . . . .

Please refer to the section above.

### 495 AUTOMATIC REVOLVING DOORS: . . . . .

### 500 MANUAL REVOLVING DOORS: . . . . .

### 520 SLIDING DOORS: . . . . .

### 610 ROLLER SHUTTERS: . . . . .

### 615 SECTIONAL OVERHEAD DOORS: . . . . .

### 680 UP AND OVER GARAGE DOORS:

Lorient's Integrity™ range includes medium and heavy duty face-fixed sweep action brushes. With a choice of brush lengths, in straight or angled carriers, they are ideal for a variety of domestic, commercial and industrial applications.



## P21 DOOR/ WINDOW IRONMONGERY

### 310 SINGLE AXIS DOOR HINGES: . . . . .

### 320 DOOR HINGES: . . . . .

### 410 OVERHEAD DOOR CLOSERS: . . . . .

### 510 THIEF RESISTANT DOOR LOCKS: . . . . .

### 515 DOOR LOCKS: . . . . .

Lorient's ironmongery protection kits are the clean and simple way to ensure intumescent protection is maintained at hinge points, and around locks and concealed door closers. Refer to the *Lorient Specialized Fire Resistant Door Furniture brochure* for more details.

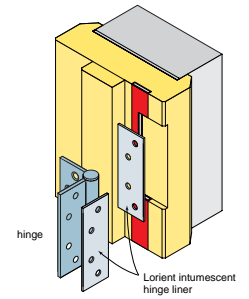

### 730 LETTER PLATES: . . . . .

### 735 INTERNAL LETTER FLAPS: . . . . .

Letterplates are an important part of door assemblies for flats and apartments – doors which must also meet the acoustic requirements of Approved Document E. The **Firemaster letterplate** from Lorient offers proven acoustic performance, as well as fire & smoke protection – and it carries CERTIFIRE certification (CF219).\*

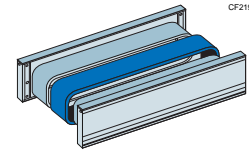

\*manufactured by Paddock Fabrications.

### 850 THRESHOLD WEATHERSTRIP: . . . . .

### 855 WEATHERSTRIP TO DOOR HEAD AND JAMBS: . . . . .

Combining the Integrity™ **IS3070** threshold seal with a threshold plate, such as the **IS4010** or **IS4015**, provides excellent weather protection for both single and double leaf doors. Use with the **IS7025** around the perimeter, and the **IS7061** at the meeting stile of double leaf doors.

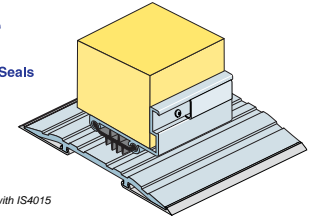

IS3070 with IS4015

### 860 DOOR SEALS FOR: . . . . . PROOFING . . . . .

All Lorient's fire & smoke seals for door assemblies and Integrity™ Architectural Seals are listed here, so the choice is yours! Our Acoustic Sealing Systems for Door Assemblies manual contains details of our numerous tested and proven acoustic solutions, to meet the requirements of Approved Document E.



### 890 DOOR VIEWERS: . . . . .

Lorient's wide angle viewer allows a clear view through a door, from a safe distance. Supplied with an intumescent liner, the viewer can be fitted to 30 minute fire resistant doors, without compromising fire safety.

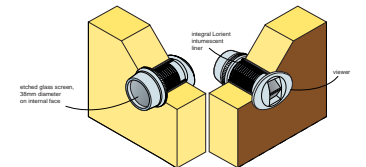

### 896 DOOR MOUNTED FIRE RESISTING AIR TRANSFER GRILLES:

### 897 DOOR MOUNTED FIRE RESISTING AIR TRANSFER GRILLES WITH SMOKE SHUTTER:

Please refer to section U90 for full details!